

21850

APR 22 1971

Name and Post Office Address of Grantor School District of Greenville County

420 N. Pleasantburg Dr. Greenville, S. C.

Toll Line (Name)

Exchange Line tributary to (Exchange)

The Property is bounded where the line enters and leaves this property by the property of:

The poles (or stakes) have the following identification:

Authority S-4688 Classification 22C Area Greenville, S. C.

Title Approved



MADE HMPT. ELEM. SCHOOL

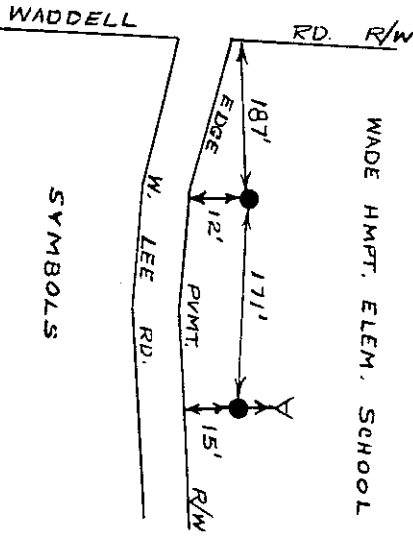

SYMBOLS
● SET & T. POLE
⊕ SET & T. ANCHOR & GUY

GEP 47.101

GENERAL PERMIT

(INDIVIDUAL)

Form 8416 Nov. '64

Received of the SOUTHERN BELL TELEPHONE AND TELEGRAPH COMPANY one and no /100 Dollars in consideration of which (I) (We) hereby grant said Company, its associated and allied companies, their respective licensees, successors and assigns, the right to construct, operate and maintain a line of communication consisting of such poles, wires, cables, conduits, guys, anchors and other necessary appurtenances as from time to time are required upon, across, over and/or under that certain tract of land situated in Greenville County, State of South Carolina, to-wit: That Tract of land bounded on the South by W. Lee Rd., the West by Waddell Rd. and the East by Edward F. Bahan.

and upon, along and under the roads, streets, or highways adjoining or through said property with the right to permit the attachment of and/or carry in conduit wires and cables of any other person or company for communications purposes or for the transmission and distribution of electric power and the right of ingress and egress to said premises at all times for the purpose of inspecting and maintaining said line and with the right to clear and keep cleared all trees, undergrowth or other obstructions within a strip of land feet on each side of the center of said line and to trim and cut and keep trimmed and cut all dead, weak, leaning or dangerous trees which might reach said line in falling; including the right to relocate said line on said premises to conform to any future highway relocation, widening or improvement; the said sum being received in full payment for the rights herein granted.

Signed, sealed and delivered in the presence of:
x Witness Joseph Klein Jr.
x Witness Mary Francis McGinty

Executed Feb 17, 1971
Wilton H. Easle, Asst. Supt. (SEAL)
for School District of Greenville County (SEAL)

FILED
GREENVILLE CO. S.C.
3:53 P.M.
FARMER
R.M.C.

Corporation Form

STATE OF SOUTH CAROLINA }
COUNTY OF } ss.

Personally appeared before me Mrs. Mary Francis McGinty who, on oath, says that (he) (she), with Joseph Klein Jr., saw Mr. Wilton H. Easle, Resist Superintendent President of the School District of Greenville County, sign and seal, and as the act and deed of said corporation, deliver the within written instrument, and that (he) (she), with

Joseph Klein Jr. witnessed the execution thereof.
Mary Francis McGinty

Sworn to and subscribed before me this 16th day of March, 1971
J.P. Lacker Notary Public

Recorded April 22, 1971 At 3:53 P.M. # 24850